



# IPP Pocket Proofer



Glimek's IPP Pocket Proofer is constructed as a modular system to accommodate customer's specified capacity and proofing times. The swings come with 6, 8 or 10 pockets as standard. Frame, swings and covers are made of stainless steel.



Sveba Dahlen Group



Scandinavian know-how – worldwide

# IPP Pocket Proofer



Non-stick coated transferbox as standard assures an interference free production



Pockets made of nylon mesh, easy to remove for cleaning, weight range 3.52 - 53 oz



Electrical control panel with all controls for the prover easy accessible

Electrical sockets provided on the electrical cabinet for power supply to and common shutdown of divider, rounder and moulder

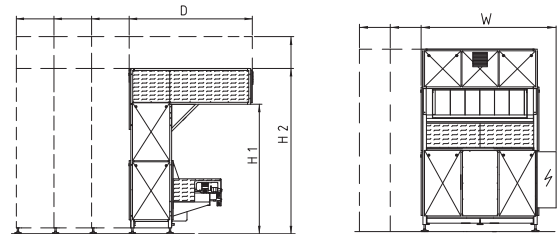

## Accessories

Infeed chute up to 1200 pcs/h (standard)	Prover runs intermittently
Single infeed V-belt up to 1800 pcs/h	Photocell controlled with continuous prover drive. Can be mounted left/right on front or backside of prover
Double infeed V-belts up to 3000 pcs/h	Photocell controlled with continuous prover drive Mounted in front and center of the prover Flapsystem feed the prover 2 pcs each time Compressed air is required
Collection drawers 6, 8 or 10 rows	Under the prover, for easy cleaning
Electrical control panel	Separate control panel under overhead projection with all controls for the prover
Electrical sockets for divider, rounder and moulder	Sockets on the electrical cabinet to provide power supply to, and common shut down of, divider, rounder and moulder
Guiding plates, non-stick	Guiding the dough piece at the receiving swing, for very elastic dough pieces
Heating fan	Thermostat controlled fan
Humidification system, automatic	Hygrostat and thermostat controlled system Self-contained. 1/4" water supply
Outfeed cross conveyor for single infeed provers 6, 8 or 10 rows with height extension. For capacity up to 1800 pcs/h	Mounted under the outlet of the pocket prover, width = 13 1/6". Also available reversible for feeding in two directions
Outfeed cross conveyor for double infeed provers 8 or 10 rows with height extension. For capacity up to 3000 pcs/h	Mounted under the outlet of the pocket prover, frequency controlled, width = 13 1/16". Also available reversible for feeding in two directions
Outlet sliding plate covering the 3 last flaps.	Mounted under the outlet of the pocket prover, sliding the dough piece to hopper or table. Non-stick coated
Synchronized speed with dough divider	Synchronized speed between the dough divider (master) and a prover with infeed conveyor Divider has to be ordered together with the prover
Ultraviolet lighting	UV-light to protect against moisture and mould

## Technical data

Infeed systems	3 versions (see accessories)
Capacity range	max. 3000 pcs/h
Weight range	3.5 oz - 3.3 lb
Power supply	0.60 kW (min.)
Air supply (double infeed)	6 bar
Number of effective pockets	132-940

Measurements	W	D	H1	H2
6 pockets	6' 5"	6' 4"	6' 8 5/16"	8' 6 3/8"
8 pockets	7' 9 1/2"	6' 4"	6' 8 5/16"	8' 6 3/8"
10 pockets	9' 2"	6' 4"	6' 8 5/16"	8' 6 3/8"
Extra module		+ 23 15/64"		
Height extension module			+ 19 11/16"	+ 19 11/16"

Total pockets net			Swings net	Back modules	Height extension
Pockets /swing					
6	8	10			
132	176	220	22		
156	208	260	26		yes
240	320	400	40	1	
288	384	480	48	1	yes
360	480	600	60	2	
432	576	720	72	2	yes
468	624	780	78	3	
564	752	940	94	3	yes

When ordering define pockets/swing and swings net, f.ex. IPP 6/22

Infeed side left, right, front or back must be specified by order. Pls communicate delivery size.



**Glimek AB**  
 Box 124  
 S-280 64 GLIMÄKRA  
 Sweden  
 Tel. int. +46-(0)44 449 00 • Fax +46-(0)44 449 10  
 e-mail: office@glimek.se • www.glimek.se



Belshaw Adamatic Bakery Group  
 814 44th St NW  
 Suite 103  
 Auburn Washington 98001  
 USA  
 Phone: +1 732 544 8400  
 Fax: +1 732 544 0735